

Model 4200 Jogger

Model 4200 Specifications	Table of Contents
Jogging Speed Variable	1.0 Introduction Page 1
Jogging Capacity 17" x 22" x 3"	2.0 Installation Page 1
Tilt Adjustment 80° Upright to Almost Flat	3.0 Setup Page 1
Jogging Method Eccentric	4.0 Operation Page 1
Motor HP 1/6	5.0 Maintenance Page 2
Electrical Specifications 110 - 120V, 50/60Hz	Wiring Diagram Page 2
(Optional: 220 - 240V, 50/60Hz)	Reference Illustrations Page 3
Dimensions 26 3/4" x 28 1/2" x 28 1/2"	Parts List & Diagram Page 4
Shipping Weight 48 lbs. (22kg)	
Other Standard Features:	
Heavy Steel Frame	
Rugged Laminated Wood Jogging Tray	
Electronic Variable Speed Control	
Fused Overload Protection	
Suction Cup Feet Prevent "Walking"	
Jogs Tab Cards, Envelopes, Checks, Paper Sets, Collated Sets, and Other Applications	

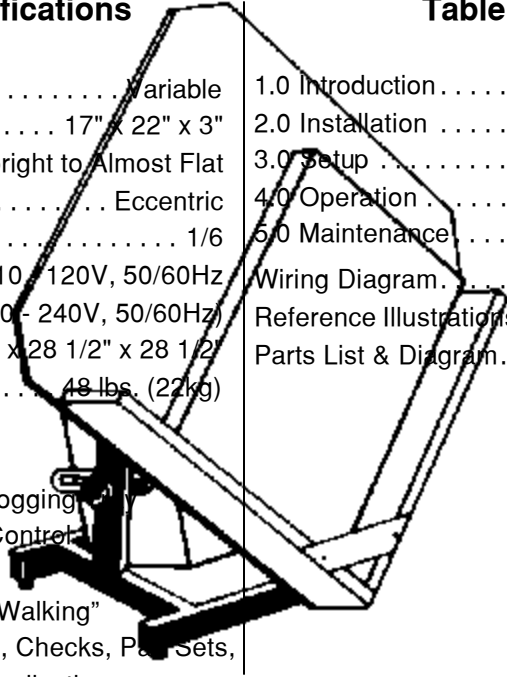

1.0 Introduction

Thank you for selecting the Martin Yale Model 4200 Jogger. The 4200 is a multi-purpose bench model jogger capable of jogging tab cards, envelopes, checks, collated sets and other forms. The 4200's heavy construction increases both longevity and productivity.

Please review this publication in its entirety before attempting to operate your 4200. Thorough understanding of this information will help eliminate most operator-associated errors and ensure years of trouble-free performance.

WARNING: *Never connect power to the machine until you are ready to set up and operate the 4200. This machine contains moving parts. During setup, operation, and maintenance keep hands, hair, loose clothing, and jewelry away from all moving parts. Serious bodily injury could result. Service, or disassembly of covers should only be attempted with the power disconnected and locked out.*

2.0 Installation

Carefully remove the 4200 from its shipping carton and place the jogger on a flat, level work surface with the wood tray down. (See Figure 1.) Thoroughly check carton contents before discarding. Carefully inspect the shipping carton and the 4200

for damage. Report any shipping damage to the carrier and your Martin Yale Dealer.

3.0 Setup

Remove the Stop Nuts from Studs on both sides of the 4200. Rotate the base up and loosen the Locking Knobs 1-2 turns on both sides of the 4200. (See Figure 2.) Position the round hole in the Slotted Brackets over the Studs on both sides of the 4200. Tighten the Locking Knobs. Reinstall the Stop Nuts snugly (DO NOT TIGHTEN) on the Studs on both sides of the 4200. Loosen the Locking Knobs and continue rotating the Base to the extreme position, closest to the Jogging Tray "V." (See Figure 3.) Rotate the 4200 by lifting the wood panel until the 4200 rests on its feet.

4.0 Operation

Adjust the wood Jogging Tray to the appropriate position for the intended jogging application. Under normal conditions, the upright position of the tray is best suited for jogging tab cards, envelopes, and checks. Tilt the tray for crisscross jogging of collated sets and similar applications. To adjust position of the tray, loosen the Locking Knobs. Move the tray to the desired location and retighten the Locking Knobs.

After proper assembly and setup, make sure the Speed Control is turned off and connect the 4200 to an electrical outlet. Turn

on the 4200 Speed Control and observe the operation of the machine. The motor should be running and the jogging tray should vibrate. To find the optimum operating speed for your 4200, tilt the Jogging Tray to a 45° angle and lock into position with the Locking Knobs. Place a full ream of paper onto the Jogging Tray.

Turn on the 4200 by rotating the Speed Control clockwise. Increase the speed until optimum jogging action is achieved. For maximum paper fluffing, edge alignment, and static dissipation, let the 4200 run for a full minute.

If the angle position of the Jogging Tray needs to be readjusted, turn off the machine. Reposition the angle of the tray into a better position and lock into place. Continue to jog paper.

Operational Hints

1. Adjust the tilt of the tray for best results. The steeper the angle of the tray, the faster the paper will jog into alignment. If the tray angle is too steep, paper that curls away from the tray may fall out. If the paper has a curl, position the paper so that the curl is toward the tray.

2. Adjust the speed control for best results. In general, larger paper requires a higher speed control setting. Jogging is the best when the paper is bouncing as individual sheets, rather than in clumps. Paper should be jogged for at least 1 minute. The jogger should be able to align paper in that 1 minute time.

5.0 Maintenance

CAUTION: *Disconnect and lock out power to the machine before attempting any maintenance or troubleshooting procedure.*

Periodically check all screws on the 4200 to make sure they are tight. Also clean the machine with a damp cloth. The circuit of the 4200 is protected by a 3 Amp slow blow fuse. Should the fuse blow, isolate the cause of the failure. Install a new fuse and restart the machine. If the fuse blows again immediately, contact your Authorized Martin Yale Dealer, or call the Martin Yale TechLine at (260)563-0641.

Model 4200 Wiring Diagram

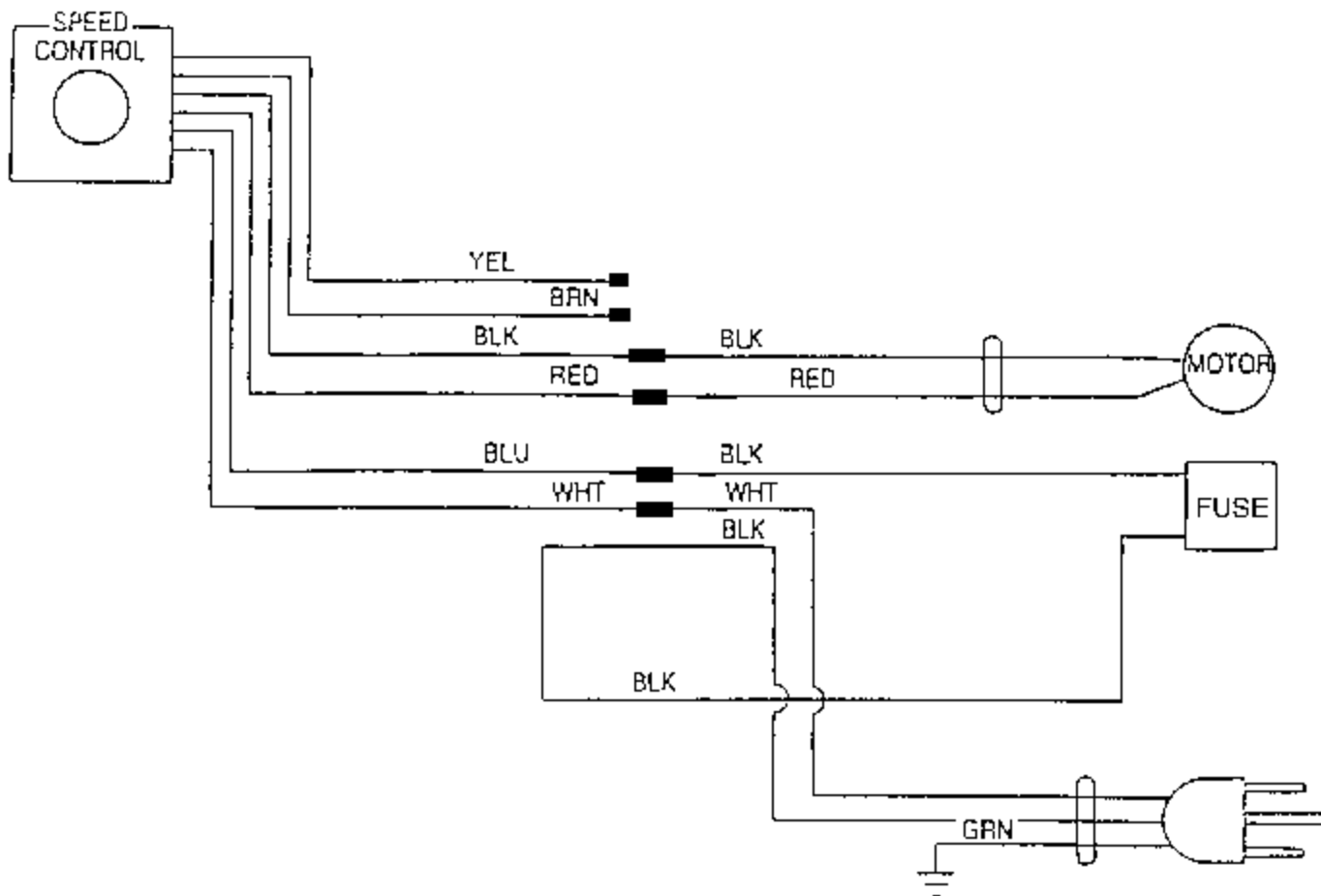

Reference Illustrations

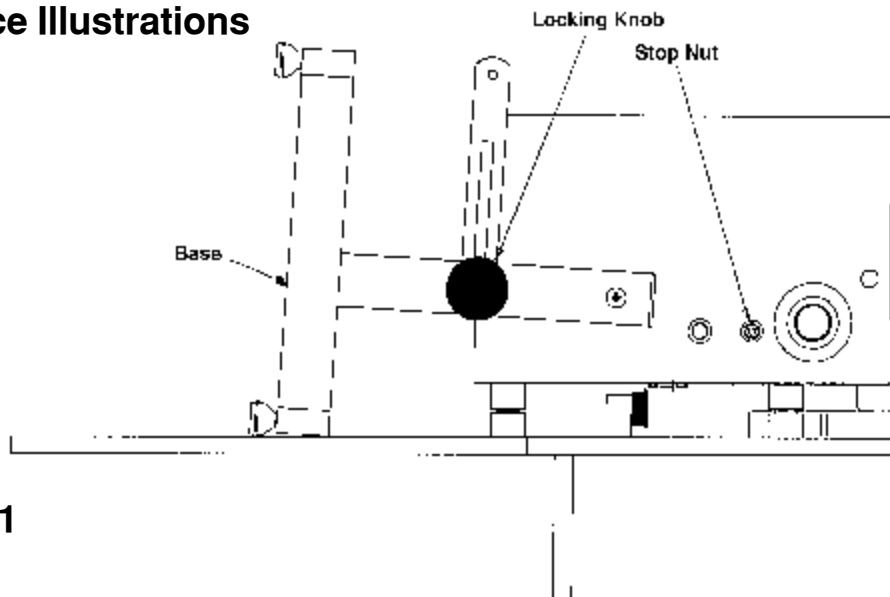

Figure 1

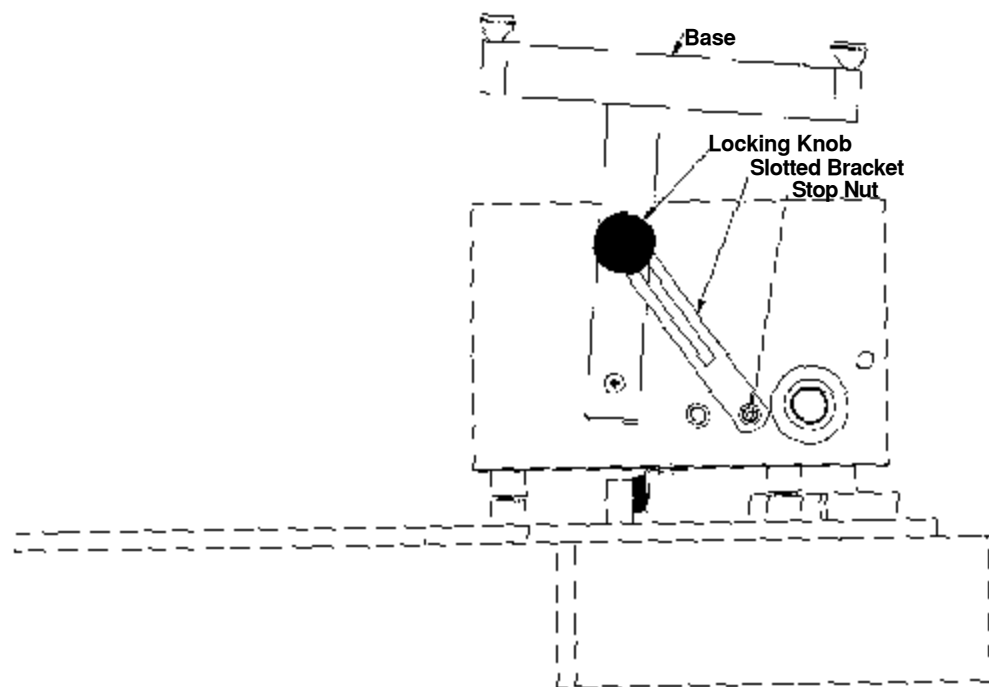

Figure 2

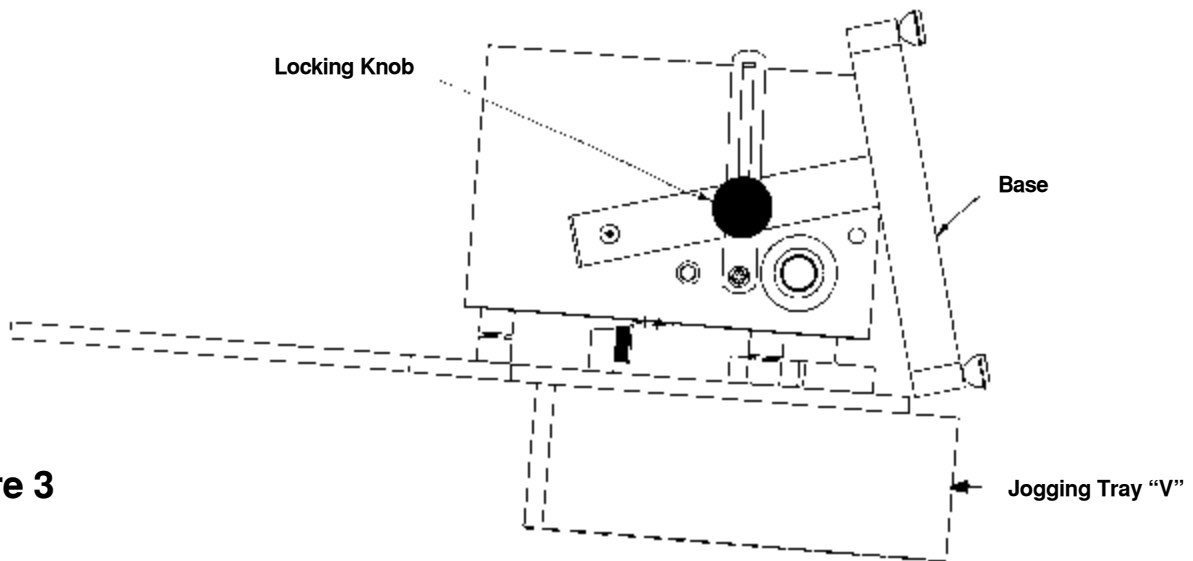
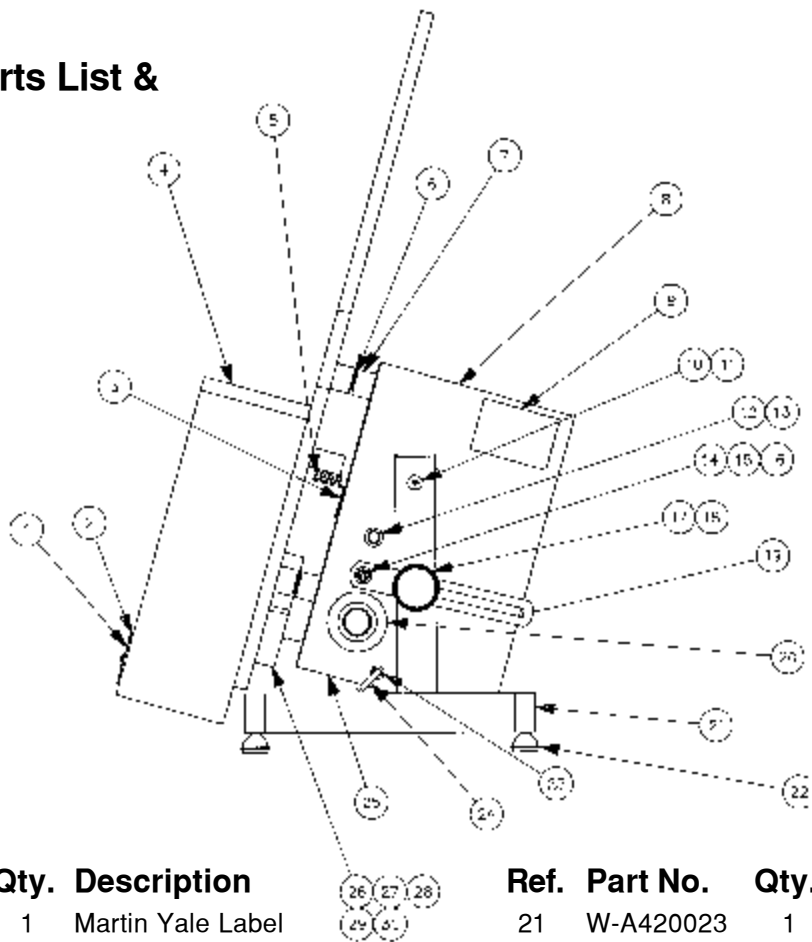

Figure 3

Model 4200 Parts List & Parts Diagram



Ref.	Part No.	Qty.	Description	Ref.	Part No.	Qty.	Description
1	M-S015014	1	Martin Yale Label	21	W-A420023	1	Stand
2	W-O420027	1	Nameplate Bracket	22	M-S030042	4	Rubber Foot
3	W-O420024	1	Cushion Bar	23	M-S035023	1	Strain Relief, Heyco #5N-4
4	M-O420001	1	Wood Tray	24	M-S037020	1	Power Cord, Type SV-18/3 (110V unit)
5	M-S030035	1	5/16x1x12 Sponge Rubber	20A	M-S037286	1	Power Cord (220V unit)
6	M-S008025	8	1/4x5/8x1/16 Flat Washer	25	W-A420004	1	Housing
7	M-S030019	8	Rubber Shock-Mount Grommet	26	W-O420011	1	Bearing Housing
8	W-O420005	1	Back	27	M-S020005	2	Ball Bearing, N.D. #7601
9	M-S015288	1	Serial Number Label	28	M-S010019	1	15/32 External Retaining Ring
10	M-O420016	2	3/8 Spacer, Nylon	29	M-S010020	1	1-5/8 Internal Retaining Ring
11	M-S001152	2	1/4-20x2 Truss Head Bolt	30	M-A420014	1	Eccentric Weight & Shaft
12	M-S045006	1	Fuse Holder	Not Shown:			
13	M-S045007	1	Fuse, 3 Amp. Slow Blow	M-O420025	1	Motor, 100 VDC, 1/6 H.P. (110V unit)	
14	M-O420017	2	1/4 Spacer, Nylon	NPN	1	Motor, 220V unit)	
15	M-S007047	2	1/4-20 Stop Nut	M-O721522	1	.06x7/16x14 Rubber Strip	
16	M-S008066	2	1/4x1/2x.01 Spring Washer	M-S027159	1	Model 4200 Instruction Manual	
17	M-S006018	2	5/16-18x1-1/4 Carriage Bolt	M-S030034	1	Coupler, Lord #J4624-19SH	
18	M-S032039	2	Knob, Black #218	W-A420010	1	Motor Bracket & Stiffener	
19	M-B420015	2	Slotted Bracket				
20	M-S045100	1	Speed Control, Dart #15DC-W1206 (110V unit)				
20A	M-S095207	1	Speed Control (220V unit)				



251 Wedcor Avenue • Wabash, IN 46992

Phone: (260) 563-0641 • Fax: (260) 563-4575

Website: www.martinyale.com • Email: info@martinyale.com